

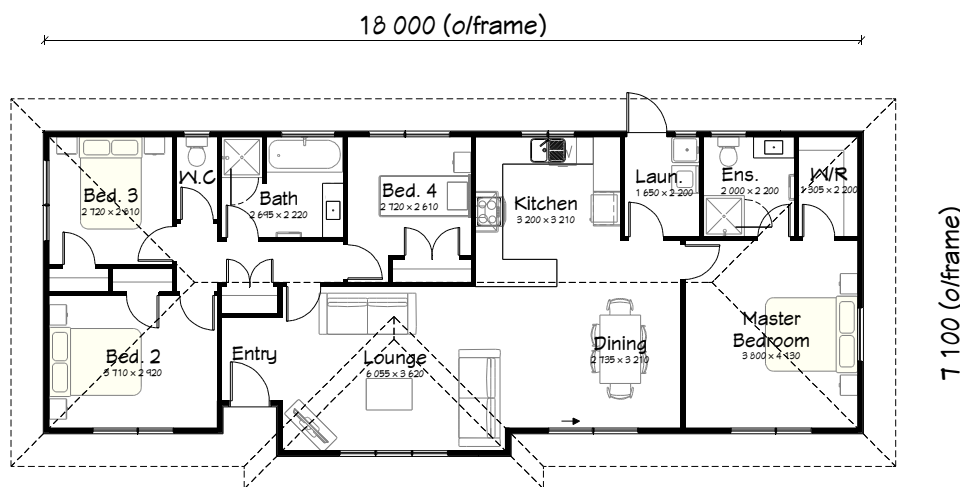

© Firsthomes 2015



L/First Homes Standard Plans/FH 4BED TRANSPORTABLE plan  
**TOTAL FLOOR AREA (o/frame) = 120.6sqM**  
**ROOF PLAN AREA = 161.3sqM**  
 APPROXIMATE Exterior wall perimeter = 51.7m  
 APPROXIMATE Interior wall perimeter = 59.7m  
 APPROXIMATE Fascia / Gutter lineal meters = 49.6m  
 APPROXIMATE Barge lineal meters = 7.2m

# FH120

TRANSPORTABLE,  
FOUR BEDROOMS,  
ENSUITE

17447 BCS 6982

TAURANGA OFFICE



027 404 1311



tgasales@firsthomes.nz

CHRISTCHURCH OFFICE



021 575 545



chchsales@firsthomes.nz